

# MAP 3

## Haines Borough Selections

### ADL 108105

Parcel 3 - Lynn Sisters

T. 039S, R. 062E, CRM

### Haines Borough Municipal Entitlement

 Proposed Conveyance

### Other Land Status

 State TA or Patented

 U.S. Forest Service

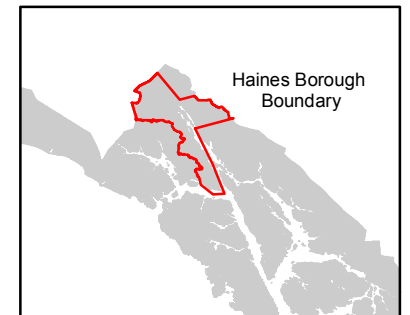
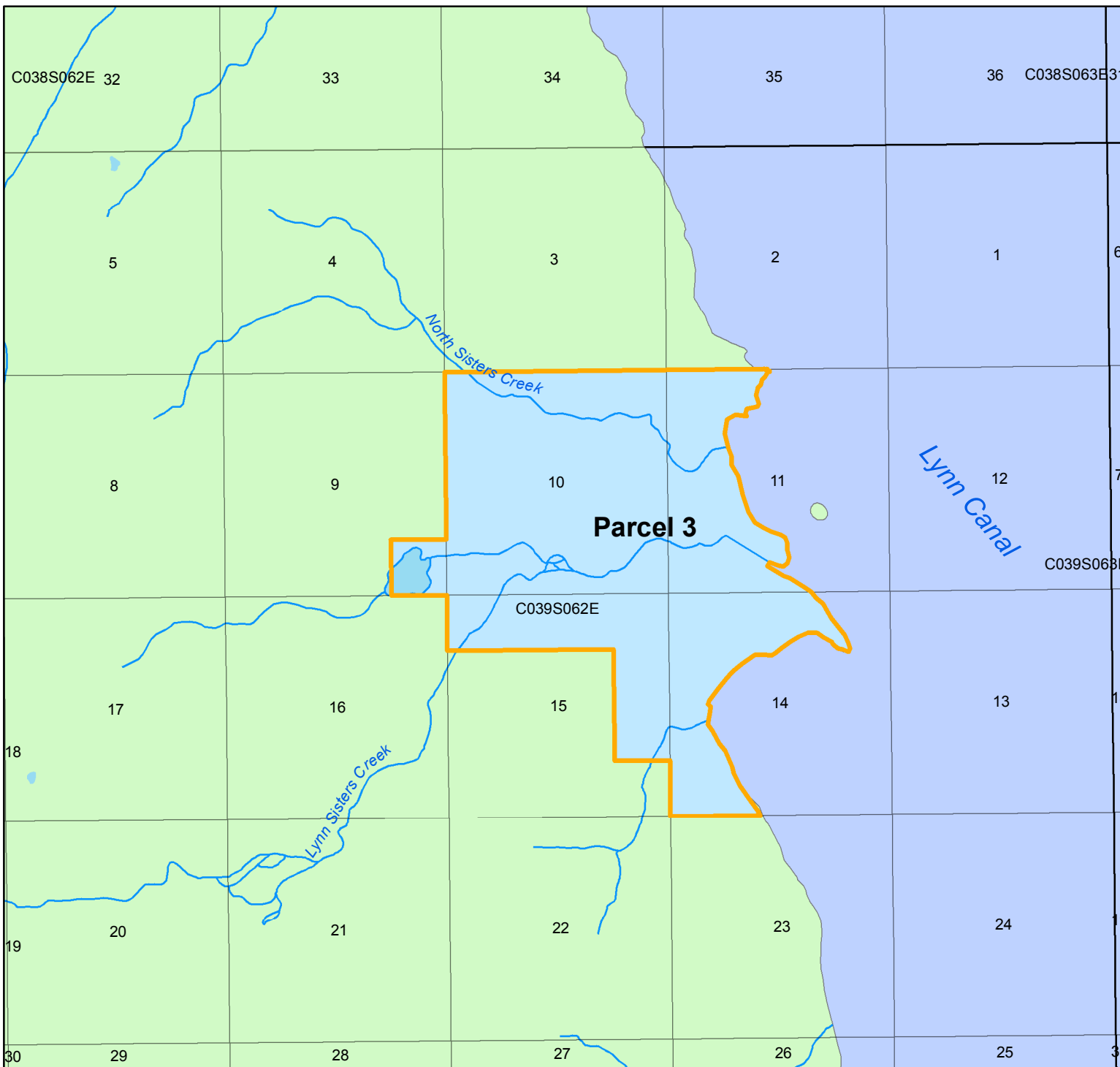



**Alaska**  
**Department of Natural Resources**  
Division of Mining, Land & Water  
Resource Assessment & Development Section  
Municipal Entitlement Unit

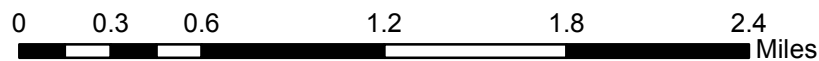

Revised:  
10/11/2017

NAD 83  
1:40,000



This map is for graphic representation only. It is intended to be used as a guiden only and may not show the exact location of existing surveyed parcels or show all easements and reservations. Source documents remain the official record.