

MANAGEMENT UNIT 22: Mount Drum Bluffs

Background

This management unit consists of two tracts of state-owned and selected-land east of the Copper River. One tract is across from Glennallen and Gulkana; the other is north of the Sanford River. The land lies within the boundary of Wrangell - St. Elias National Preserve.

Management Intent

The entire unit should be retained in public ownership and managed for multiple use. The entire area remains open to mineral entry. Management subunit 22A has potential for agriculture, settlement, public recreation, forestry, and wildlife habitat. Resource Management has been designated the subunit's primary use due to the difficulty of access across the river for any resource development and the lack of demand for these resources in the foreseeable future. Under this designation, the land will be retained and managed for multiple use in the near term and be evaluated for more intensive management or land offering in the future. Land adjacent to the Copper River in T. 5 N., R. 1 W., Section 31, will be retained in public ownership and managed for public recreation (including camping) and wildlife habitat. This is one of two state-owned parcels of land that abuts the Copper River from Indian River to below Chitina.

Subunit 22B, if conveyed to the state, will be managed for multiple use with emphasis on wildlife habitat and forestry and will be open to mineral entry. Subunit 22C, if conveyed to the state, will be managed for multiple use with emphasis on wildlife habitat. This land also provides important access for hunting across the Copper River from Gakona.

Management Guidelines

The complete set of management guidelines is presented in Chapter 2. Any of the guidelines could apply to uses within this management unit; however, guidelines that are most likely to apply are:

- Fish and wildlife habitat
- Forestry
- Public access

LAND USE DESIGNATION SUMMARY
MANAGEMENT UNIT: 22 - Mount Drum Bluffs

SUBUNIT	LAND OWNERSHIP (GENERALIZED)	LAND USE DESIGNATIONS				PROHIBITED SURFACE USE(S)*	COMMENTS
		SURFACE		SUBSURFACE			
		PRIMARY USE(S)	SECONDARY USE(S)	LOCATABLE MINERALS	LEASEABLE MINERALS		
22A	State	Resource management		Open to mineral entry	Available for leasing	Land offerings Remote cabins	
22B	State selected	Forestry Wildlife habitat		Open to mineral entry	Available for leasing	Land offerings Remote cabins	
22C	State, Native selected	Wildlife habitat		Open to mineral entry	Available for leasing	Land offerings Remote cabins	

* Other uses such as material sales, land leases, or permits, that are not specifically prohibited may be allowed. Such uses will be allowed if consistent with the management intent statement, the management guidelines of this unit, and the relevant management guidelines listed in Chapter 2.

3-148

ACE 6329528

RESOURCE INFORMATION SUMMARY

Management Unit 22 - Mount Drum Bluffs

RESOURCE	SUBUNIT		
	22A	22B	22C
Agriculture	low (w/some mod. & high)	unsuitable	unsuitable
Fish	salmon - s/r steelhead - s	none docum.	none identified
Forestry	high to mod conif. & decid.	high to mod conif. & decid.	mod. conif.
Historic-Cultural	unknown	unknown	unknown
Minerals	outside of known mineral terranes	outside of known mineral terranes	outside of known mineral terranes
Oil and Gas	low	low	low
Recreation	high along low Copper River; floating	low	mod.
Settlement Suitability	low to moderate	low	low
Transportation	land is east of Copper River; navigable	none; land is east of Copper River	accessible by float or ski plan
Wildlife	B-2 habitat; B-1 habitat	B-2 habitat; B-1 habitat, some swan nesting habitat	B-1 habitat, access for hunting

Important trails:

Subunits 22A and 22B: 17(b) easement from Copper River due east; leaves river east of Gulkana airport. Trail continues into Wrangell - St. Elias National Park and Preserve

For definitions of ratings, see glossary. For more detailed information on any resources, see resource elements published under separate cover.

MANAGEMENT UNIT 22

Mt. Drum Bluffs

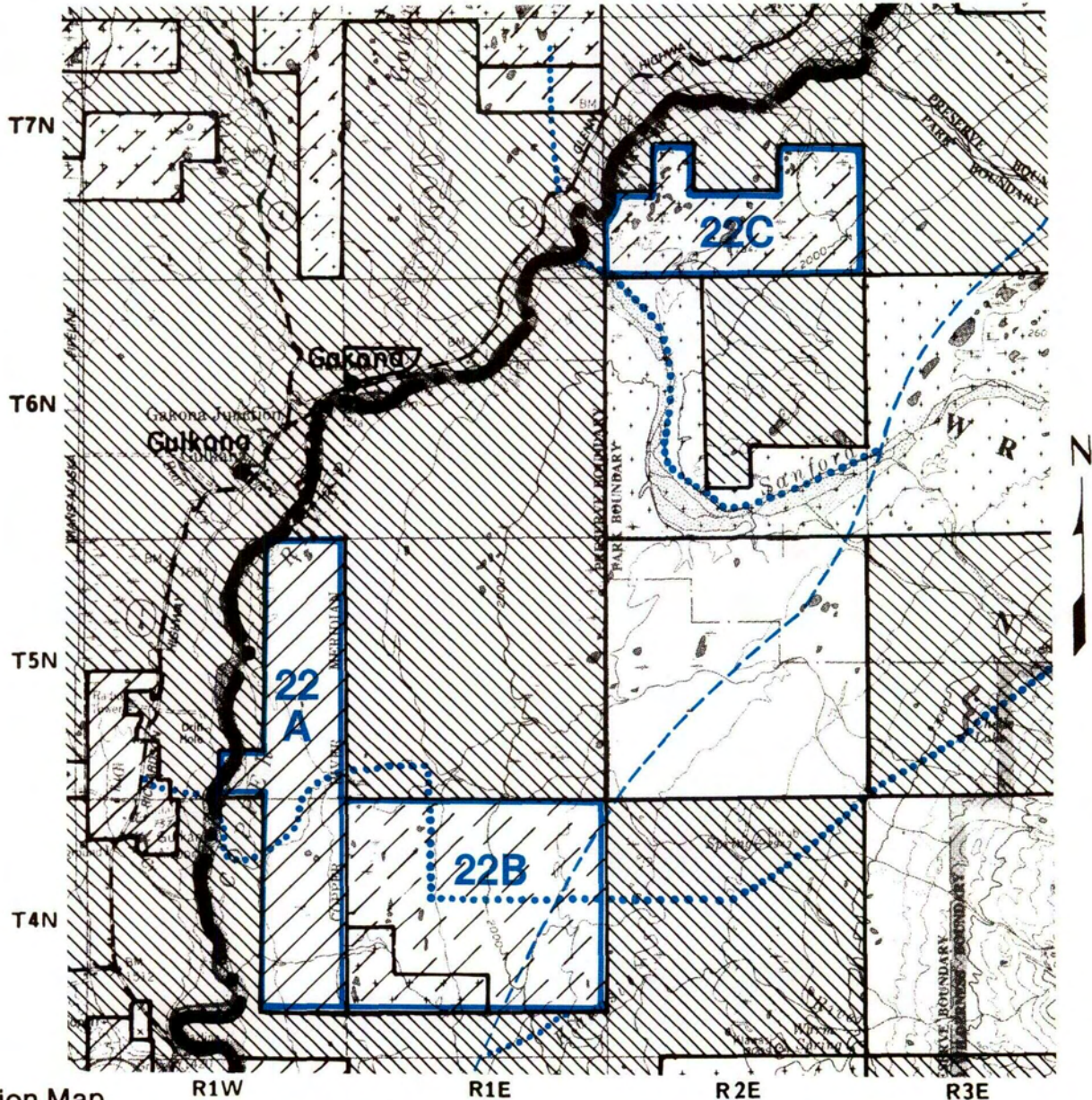



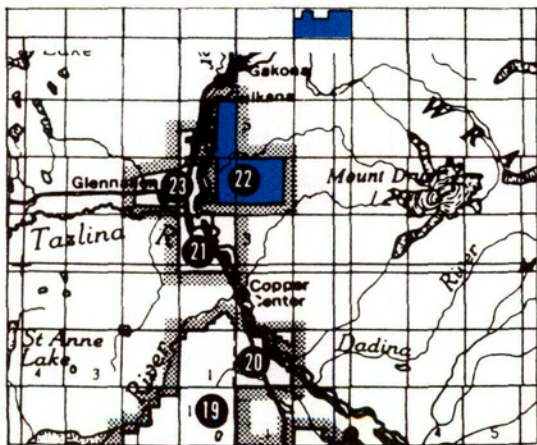

Location Map

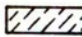

U.S.G.S. Quad:
Gulkana

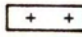
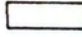
Map scale:
1:250,000

-  State Owned
-  State Selected
-  Native/Private Owned
-  Native Selected
-  Federal
-  Trails on public lands
-  Public easements to state land - ANCSA 17(b)

Map shows approximate location of easements to state land and major trails across state land. Portions of trails may cross private lands. See appendix D.