

GULKANA B4

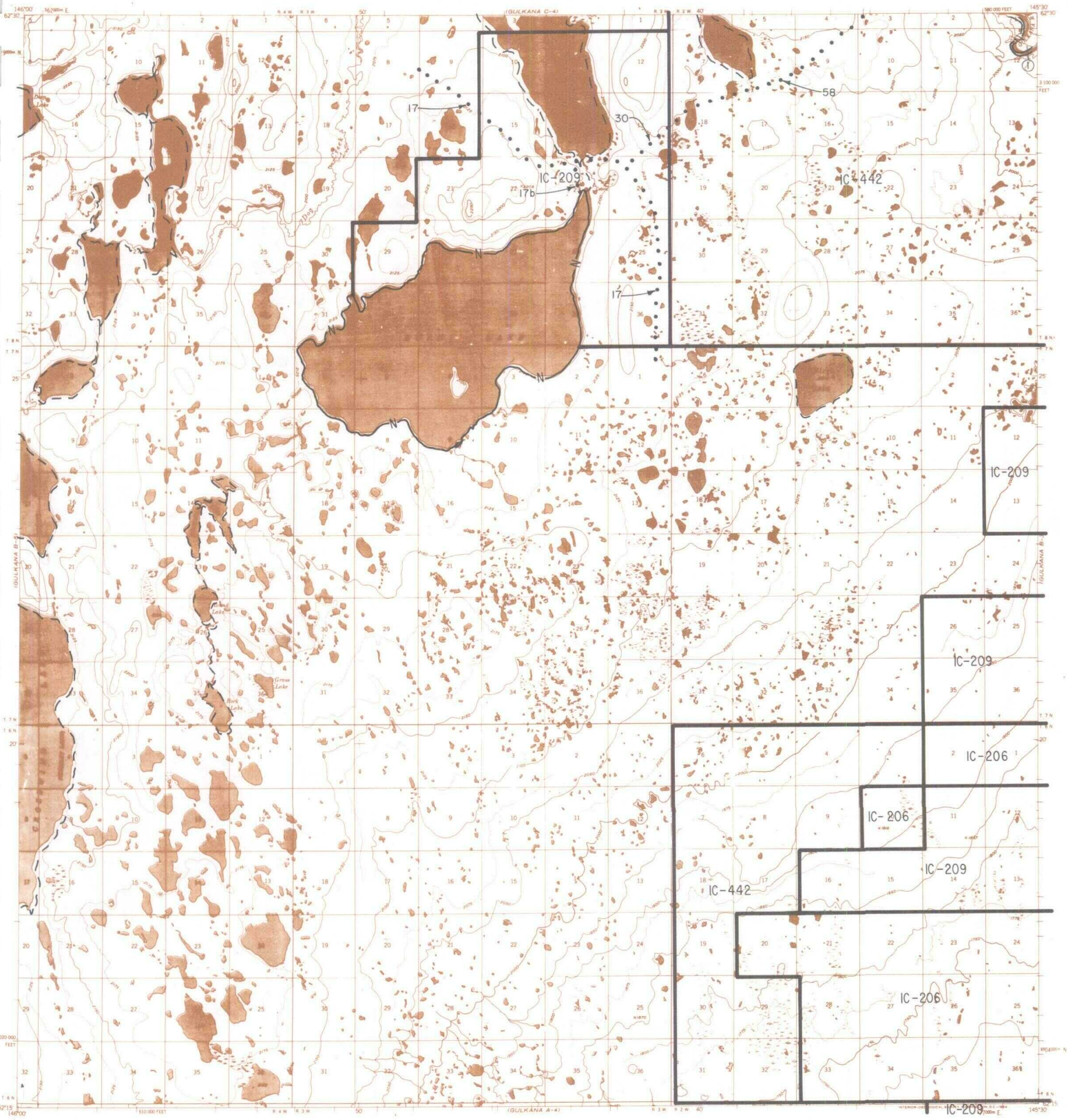

IC OR PATENT BDY.	FEDERALLY DETERMINED NAVIGABLE	OTHER AREA BDY.	 SCALE IN MILES June 1987	
WATER EXCLUSION BDY.	STATE DETERMINED NAVIGABLE	EASEMENTS & ACCESS ROUTES		

RESERVED EASEMENTS

- EIN 17 An easement for an existing access trail fifty (50) feet in width from the south border of Sec. 36, T.8N., R.3W., C.R.M., northerly and northwesterly between Ewan Lake and Middle Lake to public lands in Sec. 9, T.8N., R.3W., C.R.M.
- EIN 17b An easement for a proposed access trail twenty-five (25) feet in width from the north shore of Ewan Lake in Sec. 23, T.8N., R.3W., C.R.M., northerly to trail EIN 17.
- EIN 30 An easement for an existing access trail fifty (50) feet in width from trail easement EIN 17 in Sec. 24, northeasterly to connect with EIN 58 and on to public lands.
- EIN 58 An easement for an existing access trail, fifty (50) feet in width in Sec. 3, T.8N., R.2W., C.R.M., southwesterly to join the end of Gulkana Village trail EIN 30.