

Note: The Recreation Rivers includes only Bulchitna Lake water column and shorelands.

- Management Unit Boundary
- Subunit Boundary
- River Mile
- Private Land
- State Land
- Public Use Sites
- Special Management Areas
- Voluntary No-wake Area (May 15 - August 20)
- Borough Land

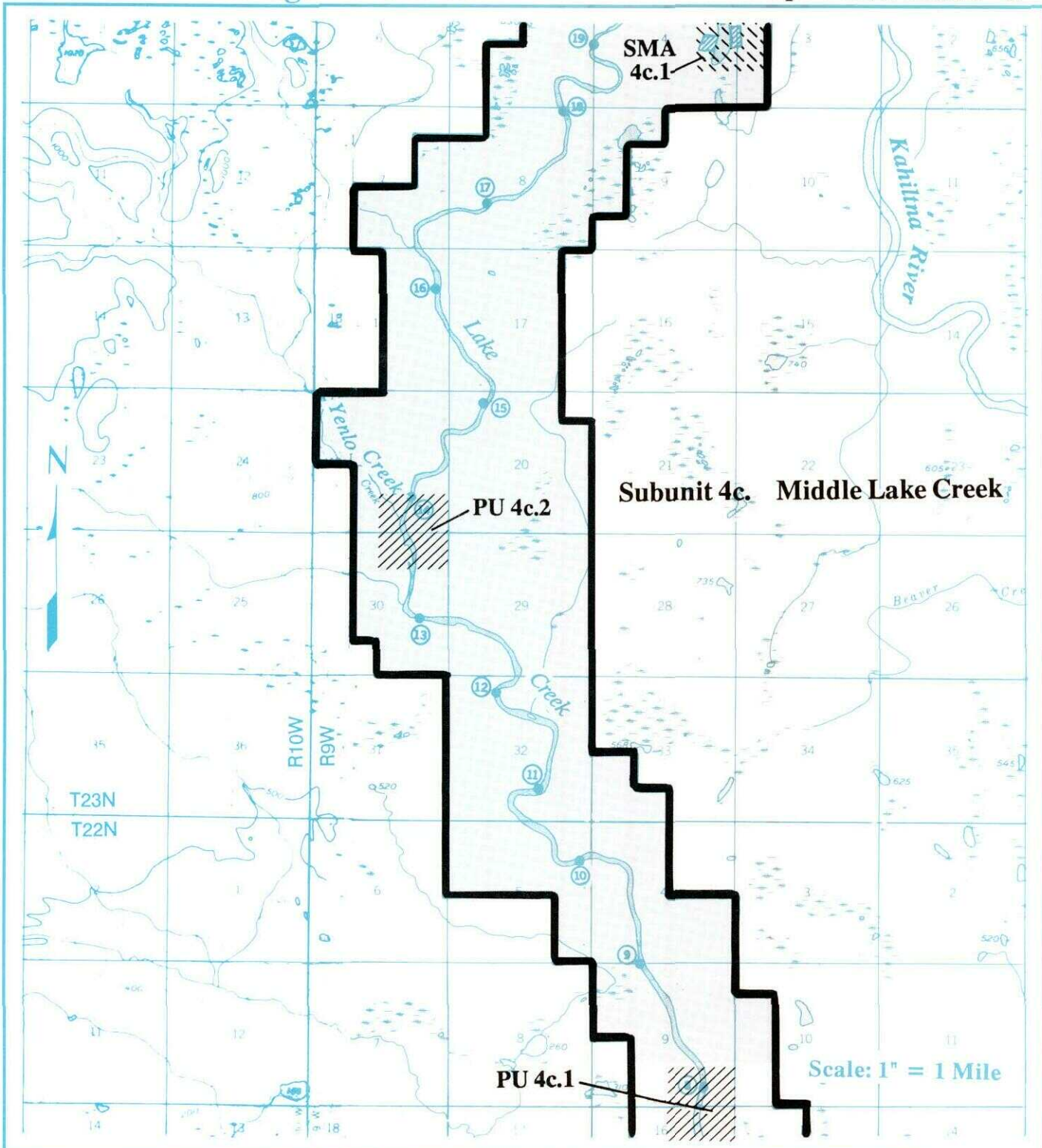



- Management Unit Boundary
- - -** Subunit Boundary
- ①** River Mile
- ▨** Private Land
- State Land

- ▨** Public Use Sites
- ▨** Special Management Areas

**Non-motorized Area**  
(May 15 - August 20)



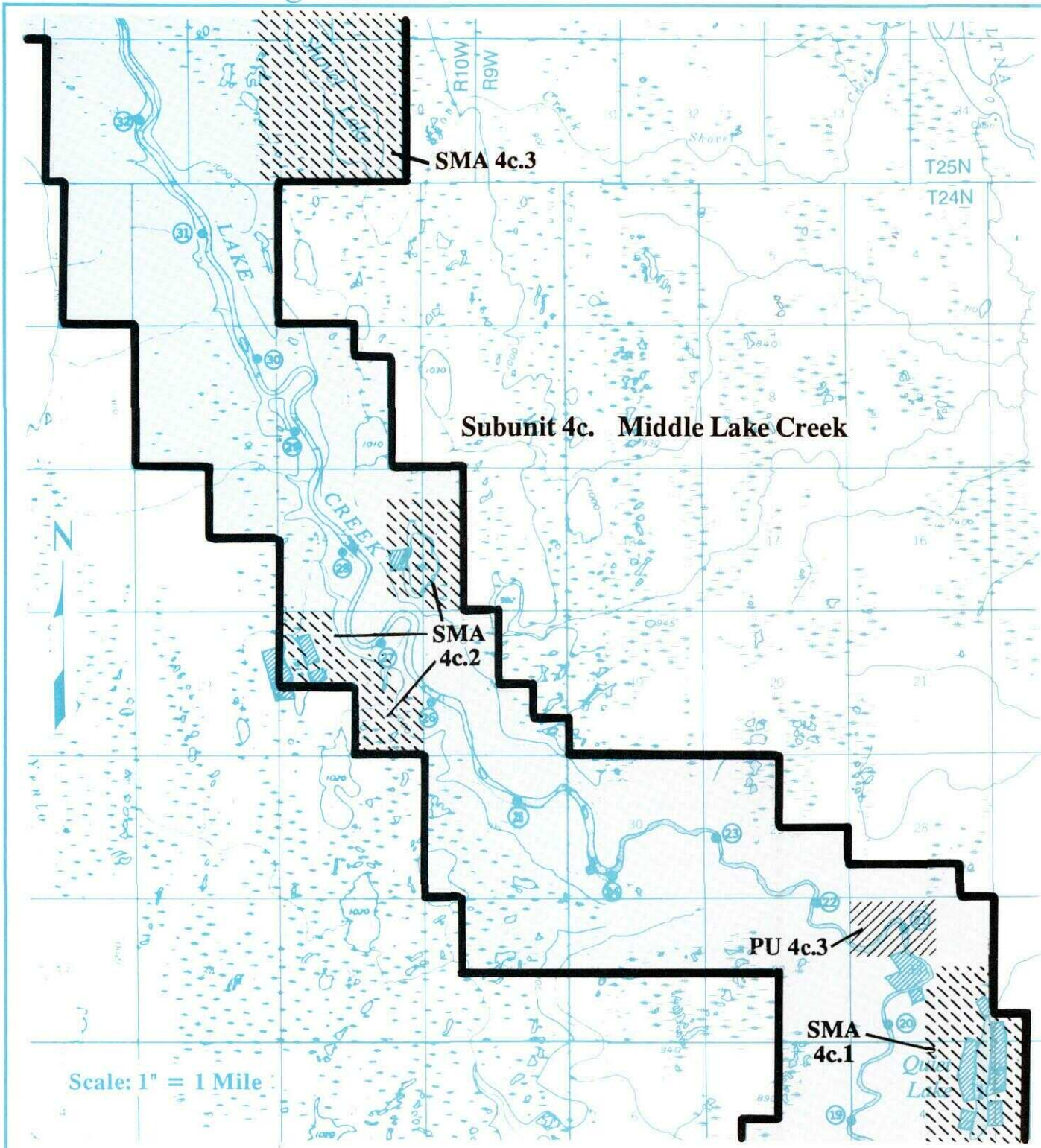

- Management Unit Boundary
- - -** Subunit Boundary
- ①** River Mile
- ▨** Private Land
- State Land

- ▨** Public Use Sites
- ▨** Special Management Areas
- ▨** Non-motorized Area (May 15 - August 20)



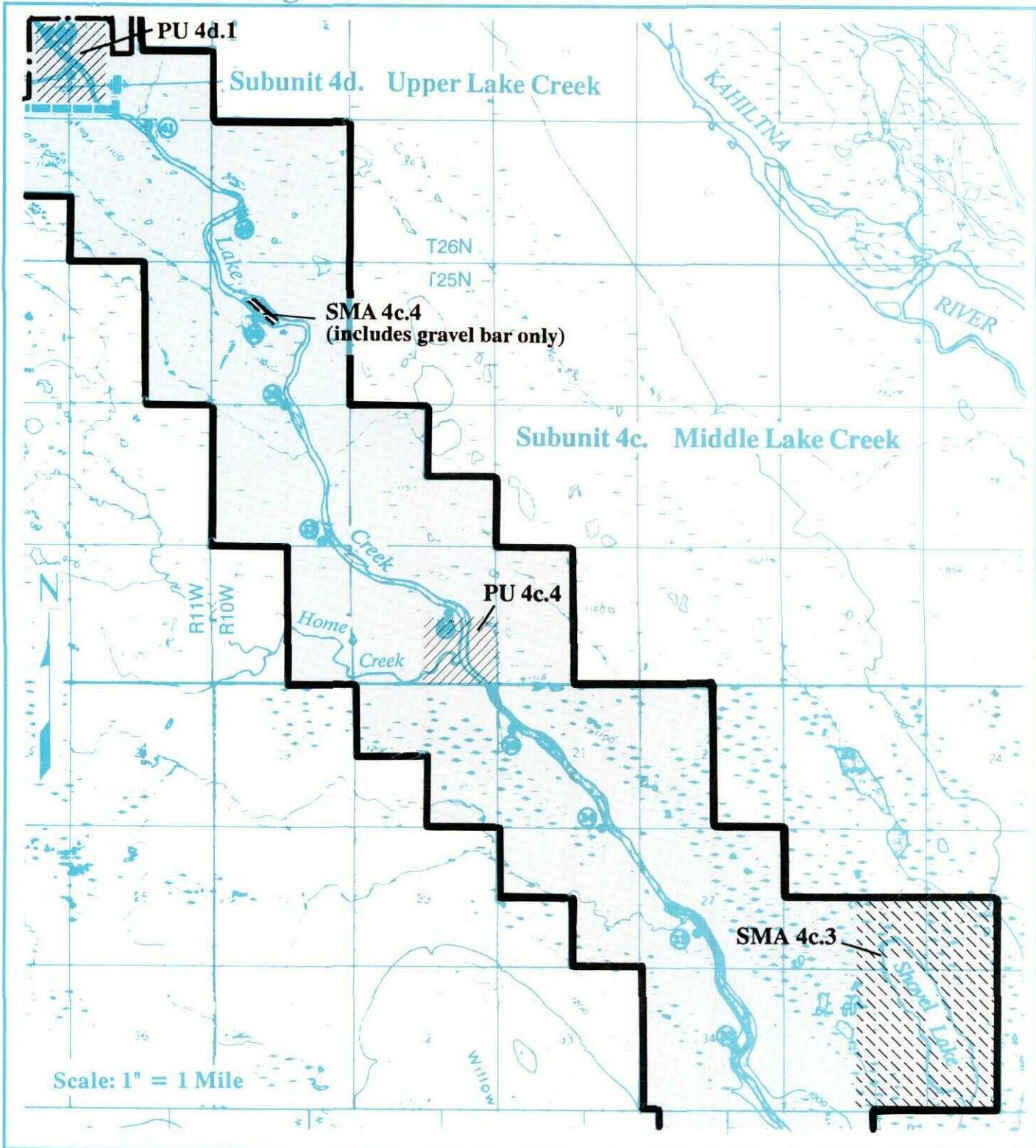

**—** Management Unit Boundary

**—** Subunit Boundary

① River Mile

□ State Land

**▨** Public Use Sites

**▨** Special Management Areas

**○** Non-motorized Area  
(May 15-August 20)

**---** Area where rights to locatable minerals may be acquired  
only under the leasehold location system AS38.05.195



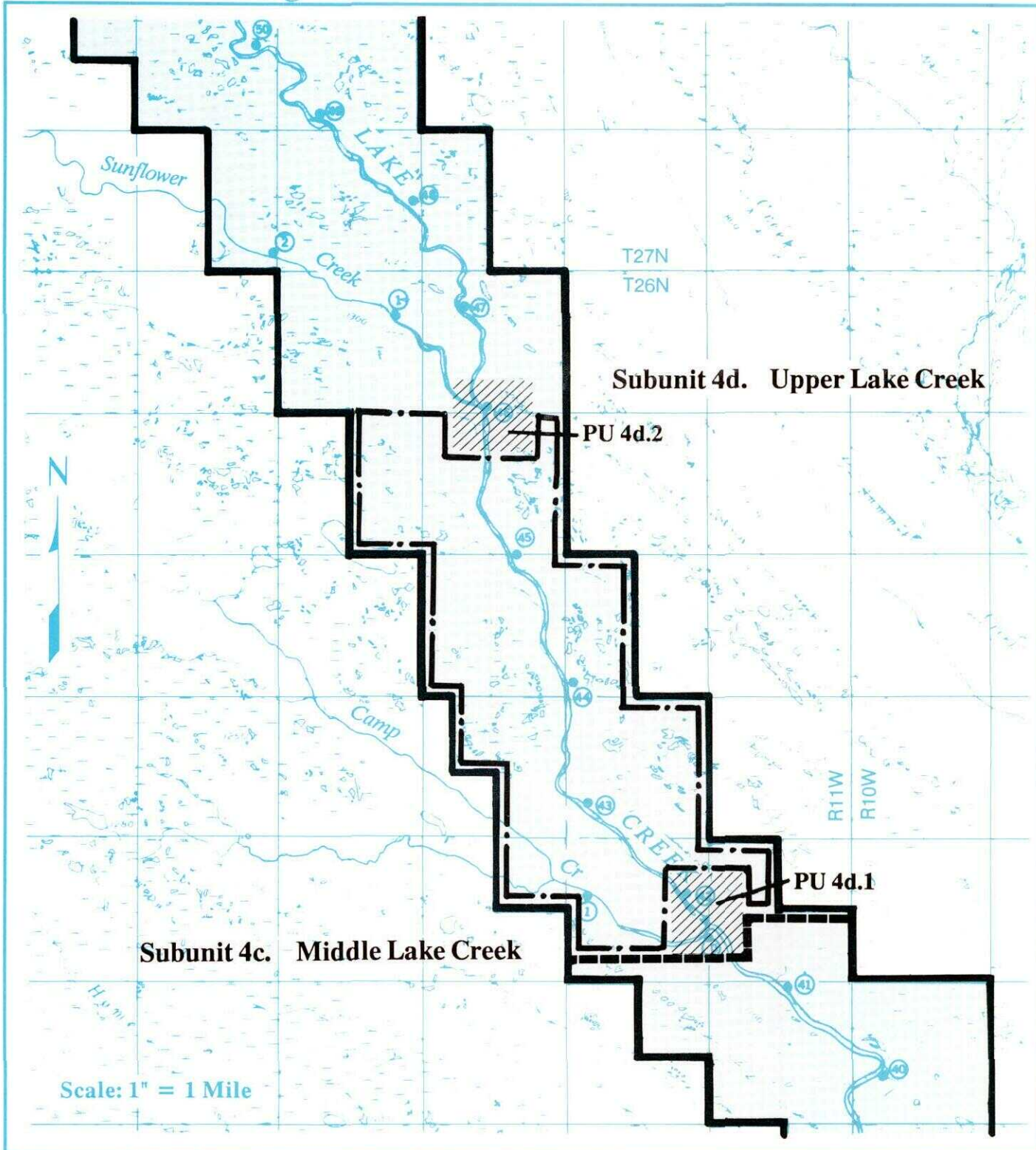

**—** Management Unit Boundary

**- - -** Subunit Boundary

① River Mile

**□** State Land

**///** Public Use Sites

**Non-motorized Area  
(May 15 - August 20)**

**- - -** Area where rights to locatable minerals may be acquired only under the leasehold location system AS38.05.195